

# Thermal-Bond Renovation Panels for Floors

**Thermal-Bond** floor panels are OSB sheathing laminated to foam. Thickness range is 1" to 3 1/2". A **Thermal-Bond** floor is ready for carpet, floating floor, linoleum over underlayment.

**Thermal-Bond** basements and crawl spaces return high dividends on investment for overall savings for the home. A warmer floor upstairs also means a lower thermostat setting to feel comfortable.

**Thermal-Bond** foam core requires no strapping or sleepers and isolates all wood from contact with cold concrete which eliminates air from insulating area and won't allow condensation and mildew to occur.

Low clearance basements will want to use the 1" thick **Thermal-Bond** while crawl spaces and high basements should use the 3 1/2" (R12.5) or 2.4" (R7.75) **Thermal-Bond**.

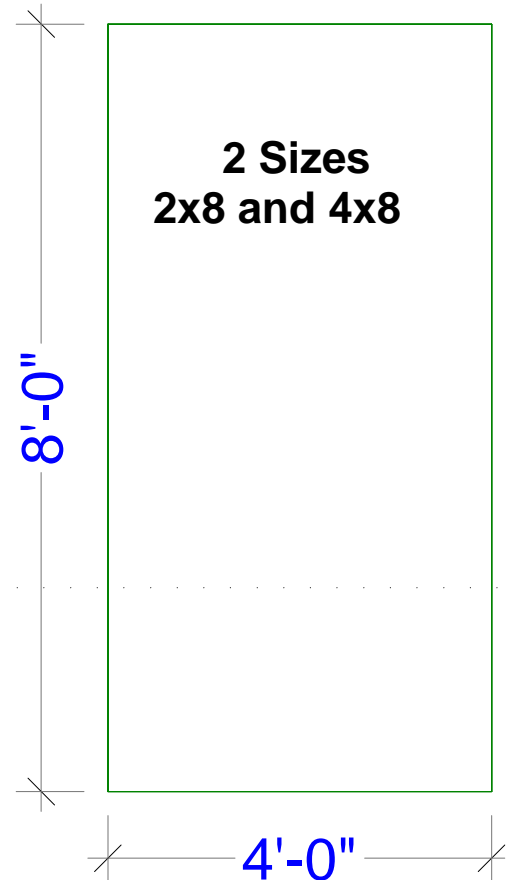
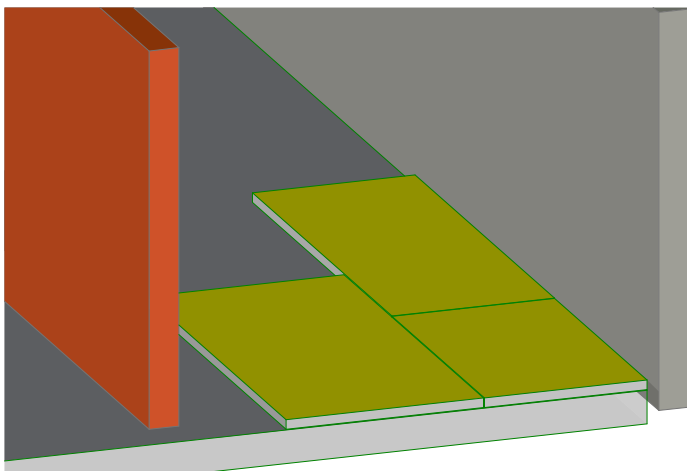

## Thicknesses (custom available)

R 12.5    3 1/2"

R 7.75    2 5/16"

R 2.5    1"



Call today for a free estimate  
250-714-4545

Design and Supply since 2001

[www.SIPbsi.com](http://www.SIPbsi.com)